

Installation of floor drain with horizontal outlet in details:

Description:

1. The minimum thickness of floor drain with horizontal outlet requires 70mm (including decorative layer)
2. When installing floor drain, do not damage the waterproof layer. If you have to make a sink hole, you should repair the damage of the waterproof layer.
3. The waterproof layer is necessary, and an additional waterproof layer is also required around the floor drain.

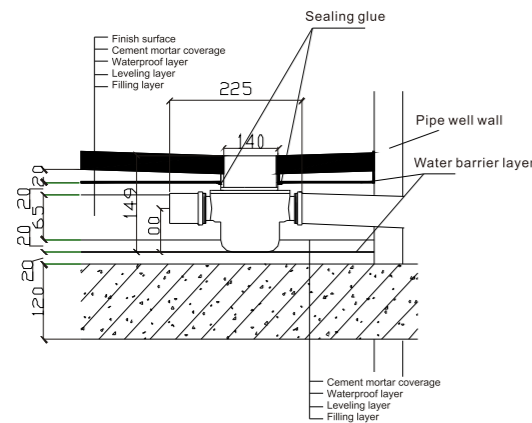

Special single riser (Sovent) connecting with horizontal pipe in details:

Description:

1. If dn75 outlet of Sovent (the downward outlet) connects with waste pipe dn50. The outlet should use an eccentric reducer 75\*50.
2. When the horizontal pipe goes through Pipe-well, apply waterproof treatment through the walls.
3. Before installing the Sovent, cut the corresponding interface base on the connection (see installation instructions).

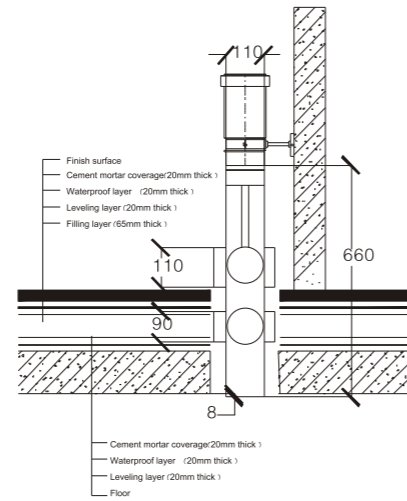
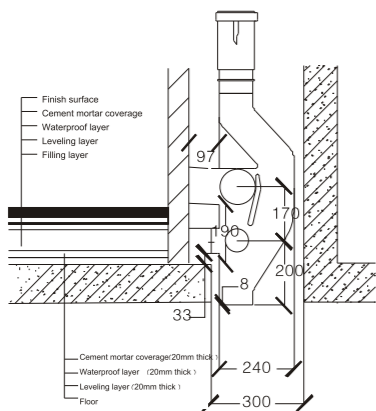

### Installation Of Concealed Cistern

Installation Detail:

1. After completing the installation of the cistern, the center of drainage pipe is 220mm above the ground; The decorative layer is 1180mm from the top of the bracket; Keep the added wall decoration from the prewall around 205~260mm.
2. When installing the bracket at the foot of the cistern, damage to the waterproof layer is strictly prohibited.
3. After passing the inspection of the concealed

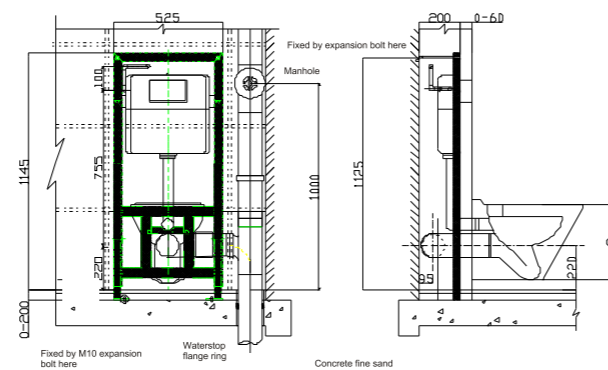

Installation of branch fitting 91.5° (88.5°), swept entry in details:

Description:

1. Sleeve is needed in the place where pipe go through the floor, on top of which an additional water proof layer is needed.
2. Upon completion of the floor, waterproofing treatment should be applied at 20~50mm high on the riser.

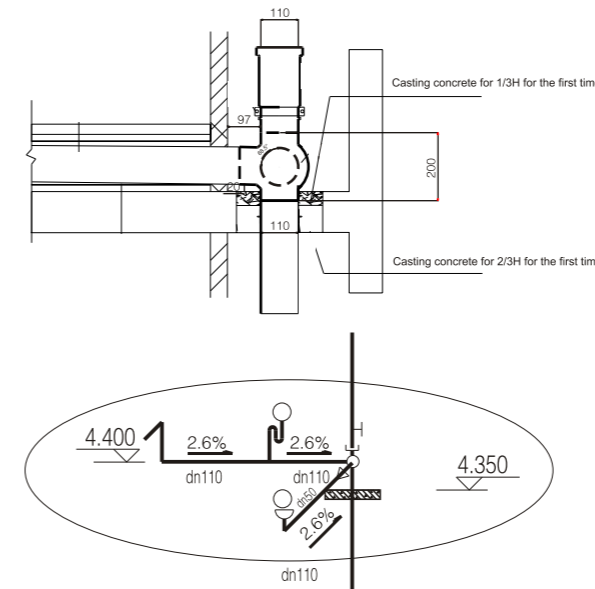

90° ball through working drawing design example

### Characteristics of a concealed cistern:

1. The key is to use silicon seal – Durable, not easily aging silicon seal from Switzerland.
2. The slow closing function of the water supply valve and noise reduction will significantly prolong the service life.
3. The valve is made of POM – does not scale and high density.
4. Modular design, it does not require any specialized tools to dismantle.

### Installation Of Double Branch Fitting In Details

Description:

1. The branch is 88.5°, install with the angle upward.
2. The bottom of the pipe which connected with branch inside cushion should be 50mm above ground level.
3. On the place where double branch fitting go through the floor should be treated with waterproof measures, filled with concrete. An additional waterproof layer can be covered.
4. Due to fire protection requirements, the pipe that goes through the ground should have fire-resistance treatment.

