

Product Name	Item Number	Specification (mm)	Package (pcs/ box)
Wire-type Tank	220244001	560*722*150	1
Machine Control Water Tank	220221001	400*710*118	1
Riser Bracket G1/2"	220238001 220238002 220238003 220238004 220238005 220238006 220238007 220238008	Dn50 Dn56 Dn63 Dn75 Dn90 Dn110 Dn125 Dn160	46 40 40 28 16 16 16 16
Welding Plate	220102001	Dn50-D160	1
PE Pipe Welding Machine	220101001 220101002	Dn50-D160 Dn50-D315	1 1
Mounting Plate	220239001 220239002	G1/2" G1"	72 48

The Layout Of Kingbull Same-floor Wall Drainage System



Kingbull same-floor wall drainage system applies the "concealed" concept, using an added wall in installation of sanitary ware in the selected location, to conceal all the horizontal drainage pipe, toilet cistern, mounting brackets and supporting frames, pipes are laid along the wall and connected to the floor main drainage at the same designated position. Bathroom interior ceiling may no longer needed and reserved hole on the floor are no longer needed. The added wall can also have versatile use. Kingbull same-floor wall drainage system would increase the space usage and aesthetics of your bathroom.

◎ The Pre-conditions Of Drainage Pipe Installation.

- 1) Approved complete Design and technical documents.
- 2) Technically verified Design and Approved installation plan and construction programs .
- 3) Construction materials has passed inspection, construction labours and equipments are ready to guarantee smooth operation and satisfy project quality requirements.
- 4) Contractor should have the appropriate qualifications.
- 5) Before installation, surface quality inspection of pipe and fitting quality should be carried out once again. Pipe with cracks, dents and deep scratches on its end should not be used in the project. Rubber parts should also be checked, special rubber items should be supplied by Kingbull.
- 6) Work field should have the necessary pipe installation technical standards, a sound quality management system and project quality inspection system therefore exercise quality control in the whole construction process. Installation personnel should be familiar with the general properties and installation methods of various types of pipe materials, and shall NOT install unfamiliar products.
- 7) When the temperature difference is too big between storage place and work site, pipe and fitting need to be placed on the site for some time to allow the surface temperature to get closer to the construction environment before the installation could commence.

◎ The connection methods of HDPE Drainage pipe

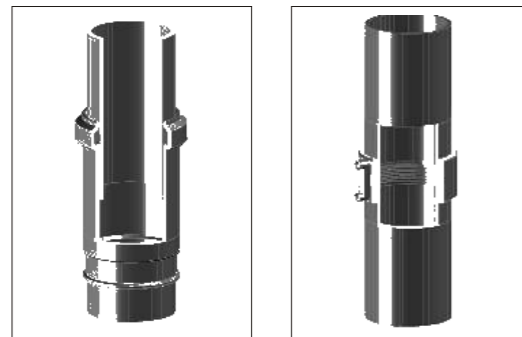

Ring-seal socket joint

Electroweld Coupling



Flanged Joint

Butt welding

The connection methods of HDPE drainage pipe should comply with the following design requirements

1. Thermo fusion welding connections or non-exposed type electroweld coupling;
2. Using pipe cutting machine, cutting incision should be vertical to the pipe center;
3. cutting surface should be kept clean, should not come in contact with other objects;
4. During welding, the operating strength and temperature should be according to requirements;
5. The height of butt welds should be consistent with the provisions in Table 3.2.1;
6. The connection axis lines should be consistent, deviation should not exceed 2mm.

◎ Principle Of Drainage Pipe Arrangement

According to the types of ventilation, drainage riser is divided into the following 4 types: ordinary ventilation by roof, ventilation by specialized riser, ventilation by special single riser and no ventilation. The maximum discharge capacities of those 4 types are as the right table:

The connection of HDPE Drain pipe with cast iron or other metals should use to specially designed parts. When seal the connection with the cement, the plastic pipe insert part need first to be processed by sandpaper, then apply adhesive and sprinkle dry sand before inserting it into the cast iron pipe's bearing end, then evenly fill in with flax and finally seal the connection with cement.

In the bathroom, the drainage riser should be installed in a place where it is possible to leave inspection accesses.

Secondly, the horizontal drainage should have slope to ensure that water can flow back into the riser.

Furthermore the same floor drainage connector has two waste water drainage accesses, sanitary ware of different side can be connected into each access, to avoid unnecessary cross of drainage pipe.

Ventilation conditions	Operating height of riser (m)	Pipe diameter(dn)					
		50	75	90	110	125	160
Common roof ventilation	-	1,20	3,00	3,80	5,40	7,50	12,00
Special ventilation riser for ventilation	-	-	-	-	10,00	16,00	28,00
Roof ventilation by special fitting	-	-	-	-	6,00	9,00	13,00
No Ventilation	≤2	1	1,7	-	3,80	5,00	7,00
	3	0,64	1,35	-	2,40	3,40	5,00
	4	0,50	0,92	-	1,76	2,70	3,50
	5	0,40	0,70	-	1,36	1,90	2,80
	6	0,40	0,50	-	1,00	1,50	2,20
	7	0,40	0,50	-	0,76	1,20	2,00
	≥8	0,40	0,50	-	0,64	1,00	1,40

◎ The Installation Of Socket Section

1. Kingbull HDPE drainage Ring-Seal Socket includes the main body, O-ring, cover and Vaseline Lubricant.
2. The socket end with no seal O-ring connects with the corresponding HDPE pipes.
3. Remove the cover and lubricate the O-ring surface with Included Vaseline lubricant.
4. chamfering the corresponding pipe end with a 30 ° angle.
5. Insert the pipe into the socket until it reach the position (as shown at right).

Note:

1. The end with O ring should be upright.
2. The socket cover should not be removed before connecting with pipes.

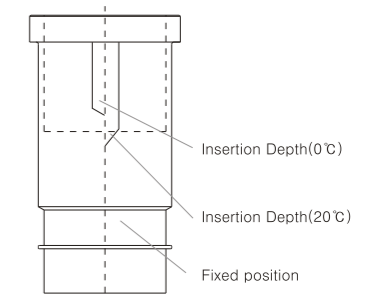
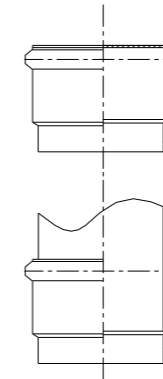

Sovent

Sovent is best installed in the pipe well, which could save the space of a ventilation tube; reduce drainage noise; improve efficiency. It's normally used in the main drainage riser, the maximum draining ability can reach 7.3L/S.



1、 Prepare the fitting Sovent



2、 Install the fitting into the welding machine



3、 Cut the end port according to required diameter

◎ The Expansion Socket

1. The end with no rubber ring connects with the corresponding HDPE pipe.
2. Remove the cover and lubricate the O-ring surface with Included Vaseline lubricant.
3. Find the corresponding depth-line on the outside of the expansion socket according to the temperature of construction site.
4. Chamfering the corresponding pipe end with a 30 ° angle.

Note:

- 1, During vertical installation, the end with O ring should be upright, it can also be used in horizontal installation.
2. Should be used in conjunction with pipe clip.
- 3, The socket cover should not be removed before connecting with pipes.
- 4, Refer to construction drawings for detailed the installation position.